

Richmond Township  
34900 School Section  
Richmond, MI 48062  
586-727-8998 Fax: 586-727-8997  
[www.richmondtp.org](http://www.richmondtp.org)

**FENCE PERMIT APPLICATION**

**If your property is zoned Agricultural-Residential, a fence permit is not required but you must follow the township setback requirements.**

Date: \_\_\_\_\_

Property Address: \_\_\_\_\_ Lot # \_\_\_\_\_  
\_\_\_\_\_ Zip: \_\_\_\_\_

Parcel Identification #: \_\_\_\_\_

Homeowner: \_\_\_\_\_ Phone: \_\_\_\_\_

Applicant: (if different from Homeowner):

Name: \_\_\_\_\_ Phone: \_\_\_\_\_

Address: \_\_\_\_\_ City: \_\_\_\_\_ State: \_\_\_\_\_ Zip: \_\_\_\_\_

Proposed Construction:

Type: \_\_\_\_\_ Length: \_\_\_\_\_ Height: \_\_\_\_\_

**REQUIREMENTS FOR FENCE**

1. Permit Application
2. Site Plan: indicating size, shape and distance from the property lines, from well, septic, other buildings, pond.
3. If you live on Fox Creek or in Hidden Meadows and/or a community with a homeowners association a letter of approval must be included from the association.
4. Completely fill in the permit application.
5. All fences must comply with the requirements in the Richmond township Zoning Ordinance Article 7 Section E.

# FENCE

## COMPLETELY FILL IN SECTION DETAILS

1. Fence Location: Rear: \_\_\_\_\_ Front: \_\_\_\_\_ Side: \_\_\_\_\_
  2. Post Size: \_\_\_\_\_
  3. Fence is constructed of the what materials?: \_\_\_\_\_
- 
4. Height of fence: Rear: \_\_\_\_\_ Side: \_\_\_\_\_ Front: \_\_\_\_\_
  5. Length of fence: Rear: \_\_\_\_\_ Side: \_\_\_\_\_ Front: \_\_\_\_\_

### Site Plan Sample

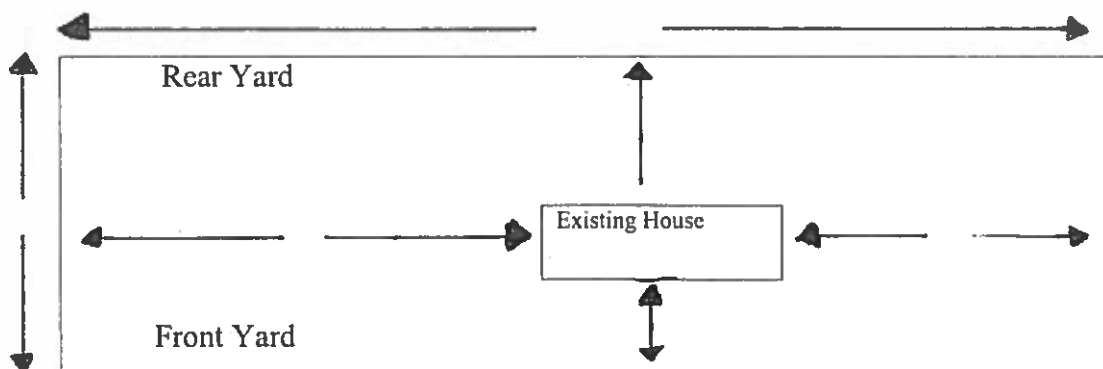

Address/Street \_\_\_\_\_ \*If corner lot, note both streets

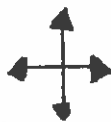

Indicate North Arrow

Approved: \_\_\_\_\_ Date: \_\_\_\_\_  
Denied: \_\_\_\_\_ Building Official

Cc: Homeowner/applicant  
File

Richmond Township Zoning Ordinance

Fence Ordinance

Article 7 Section E

*E. Fences, walls, hedges and protective barriers.*

1. The erection, construction or alteration of any fence, wall, hedge or other type of protective barrier in a single-family district shall be reviewed by the Building Inspector. The Building inspector shall approve, grant a permit to and inspect all fences that conform to the requirements of the Zoning District wherein they are proposed and the requirements of this section.
2. In any residential district, fences and walls are permitted along any lot line.
3. Unless otherwise stated, fences shall be a maximum of six (6) feet in height.
4. No fence located in the front yard, or the area of the side yard between the rear building line of the primary structure and the front yard lot line, shall be greater than forty-two (42) inches in height. Fences located in the area described herein shall be picket or wrought iron in nature.
5. No fencing shall have sharp design features and shall not contain barbed wire or razor wire.
6. All fences in Multiple-family Residential Districts shall be subject to site plan review procedures.
7. For all fences hereinafter erected, the finish side of the fence shall face the property adjacent to the proposed fence.